

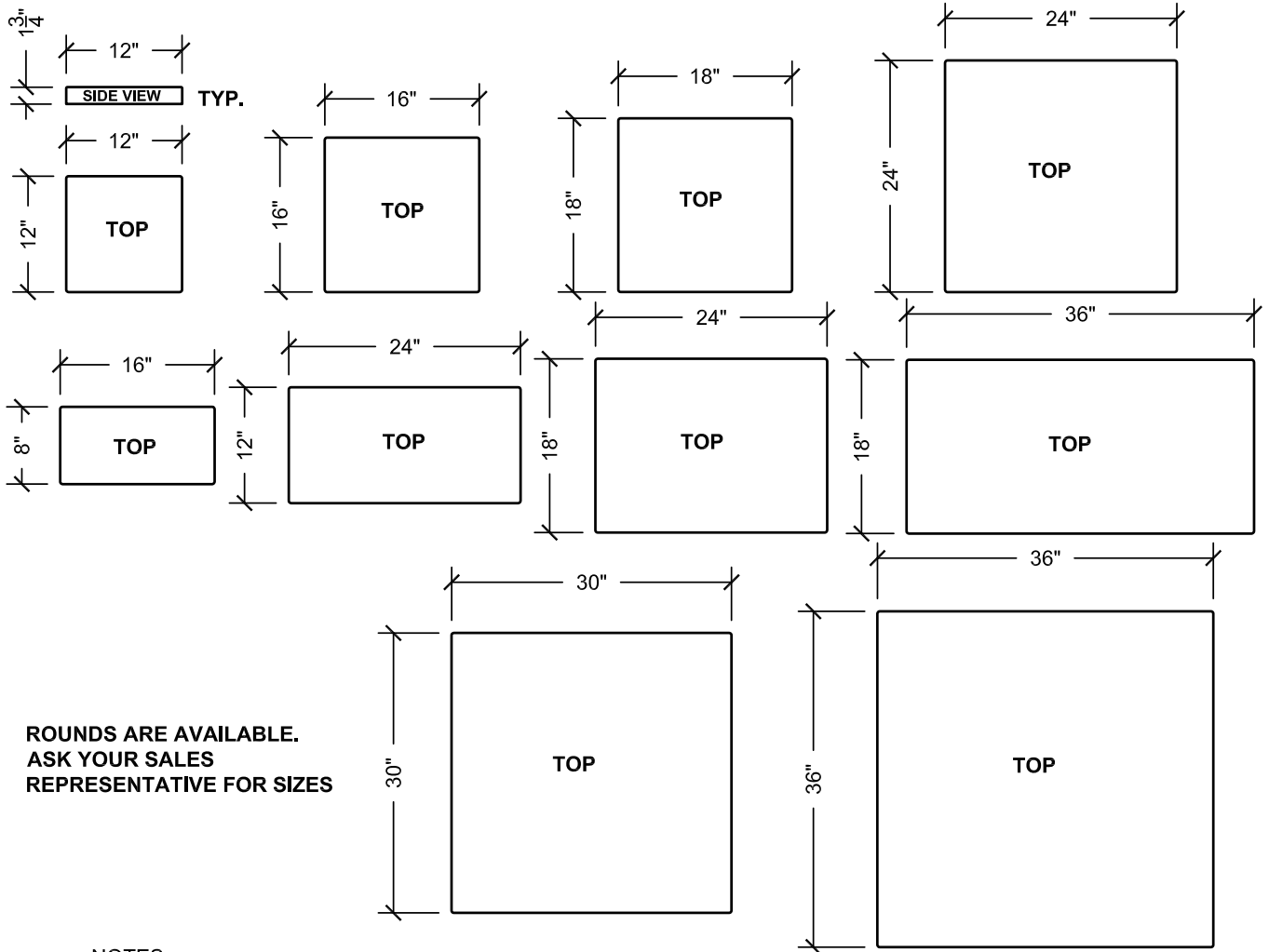

CLASSIC WALK PAVER DETAILS



ROUNDS ARE AVAILABLE.
ASK YOUR SALES
REPRESENTATIVE FOR SIZES

NOTES:

1. PRECAST CONCRETE UNITS ARE INDIVIDUALLY HAND CAST. LENGTHS ARE APPROXIMATE. SOME VARIATIONS ARE EXPECTED. CLASSIC WALK PAVERS SHALL BE 1-3/4" THICK.
2. ALL CLASSIC WALK PAVERS SHALL HAVE A MINIMUM COMPRESSIVE STRENGTH OF 4,000 P.S.I.
3. PRECAST UNIT MAY BE CUT TO FIELD CONDITIONS. INSTALLATIONS TO BE COMPLETED IN ACCORDANCE WITH GENERALLY ACCEPTED MASONRY PRACTICES.
4. SLIP-RESISTANCE CLASSIC STIPPLE AND EXPOSED AGGREGATE FINISHES AVAILABLE.
5. CLASSIC WALK PAVERS ARE AVAILABLE IN TWELVE (12) STANDARD COLORS. CUSTOM COLORS AND SIZES ARE AVAILABLE UPON REQUEST.
6. ALL DIMENSIONS ARE NOMINAL. SEE SPECIFICATIONS FOR TOLERANCES.

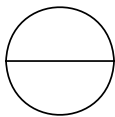

CLASSIC WALK PAVERS - GENERAL DETAILS

SCALE: N.T.S.





SONORASTONE® PAVER DETAILS

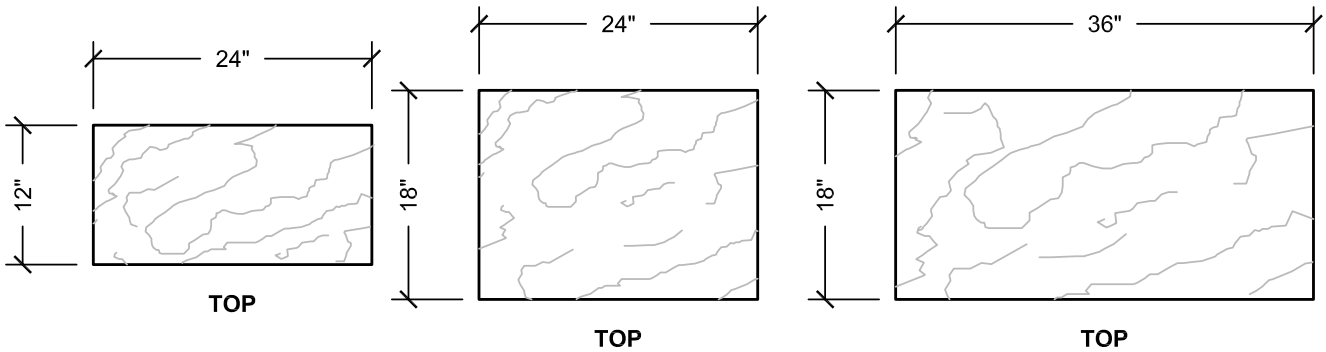
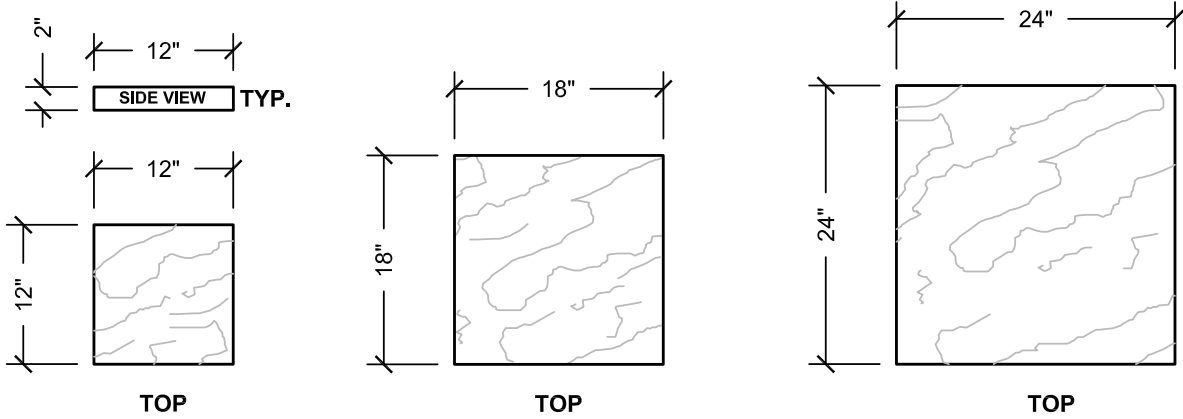

NOTES:

1. PRECAST CONCRETE UNITS ARE INDIVIDUALLY HAND CAST. LENGTHS ARE APPROXIMATE. SOME VARIATIONS ARE EXPECTED. SONORASTONE® PAVERS SHALL BE 2" THICK.
2. ALL SONORASTONE® PAVERS SHALL HAVE A MINIMUM COMPRESSIVE STRENGTH OF 4,000 P.S.I.
3. PRECAST UNIT MAY BE CUT TO FIELD CONDITIONS. INSTALLATIONS TO BE COMPLETED IN ACCORDANCE WITH GENERALLY ACCEPTED MASONRY PRACTICES.
4. SLATE FINISH.
5. SONORASTONE® PAVERS ARE AVAILABLE IN SEVEN (7) VARIEGATED COLORS AND TWELVE (12) STANDARD COLORS. CUSTOM COLORS AND SIZES MAY BE AVAILABLE UPON REQUEST.
6. ALL DIMENSIONS ARE NOMINAL. ALL SIDES HAVE DRAFT. SEE SPECIFICATIONS FOR TOLERANCES.

SONORASTONE® PAVERS - GENERAL DETAILS

SCALE: N.T.S.

Visit us at our website www.stepstoneinc.com





BORDERSTONE™ DETAILS

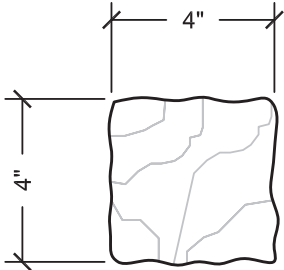

SECTION VIEW

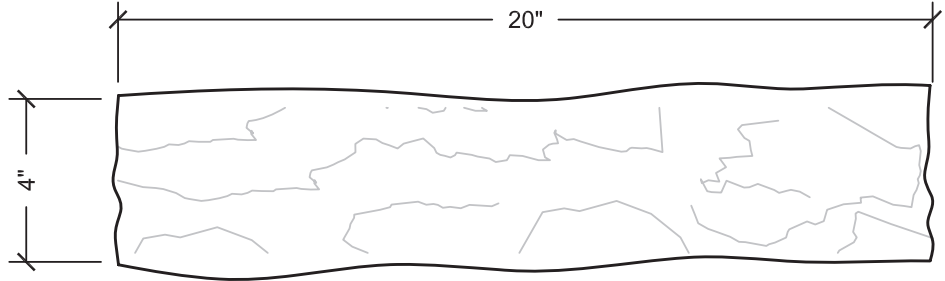

SIDE VIEW

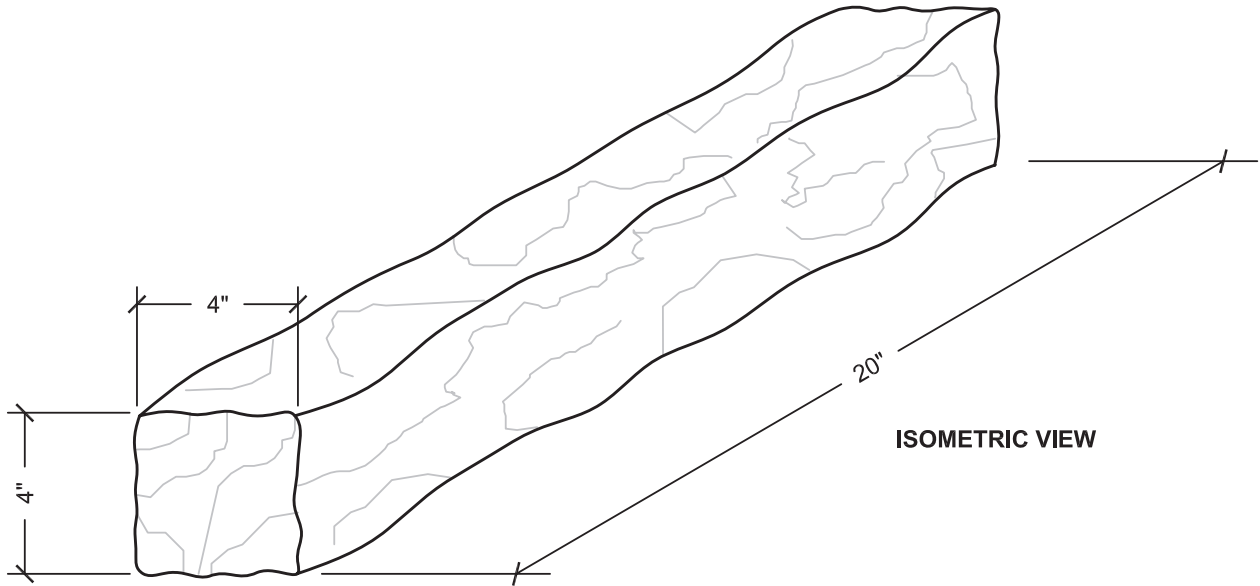

ISOMETRIC VIEW

NOTES:

1. PRECAST UNITS ARE INDIVIDUALLY HAND CAST. LENGTHS ARE APPROXIMATE. SOME VARIATIONS ARE EXPECTED.
2. BORDERSTONE™ SHALL HAVE A MINIMUM COMPRESSIVE STRENGTH OF 4,000 P.S.I.
3. PRECAST UNITS MAY BE CUT TO FIT FIELD CONDITIONS. INSTALLATION TO BE COMPLETED IN ACCORDANCE WITH GENERALLY ACCEPTED MASONRY PRACTICES.
4. SLATE FINISH ON TOP AND SIDES.
5. BORDERSTONE™ IS AVAILABLE IN SEVEN (7) VARIEGATED COLORS AND TWELVE (12) STANDARD COLORS.
6. ALL DIMENSIONS ARE NOMINAL. SEE SPECIFICATIONS FOR TOLERANCES.

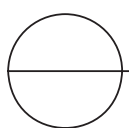

BORDERSTONE™ 20" x 4" x 4"

SCALE: N.T.S.





ASHLAR PATTERN GUIDE

PATTERN REPEATS LEFT TO RIGHT / TOP TO BOTTOM

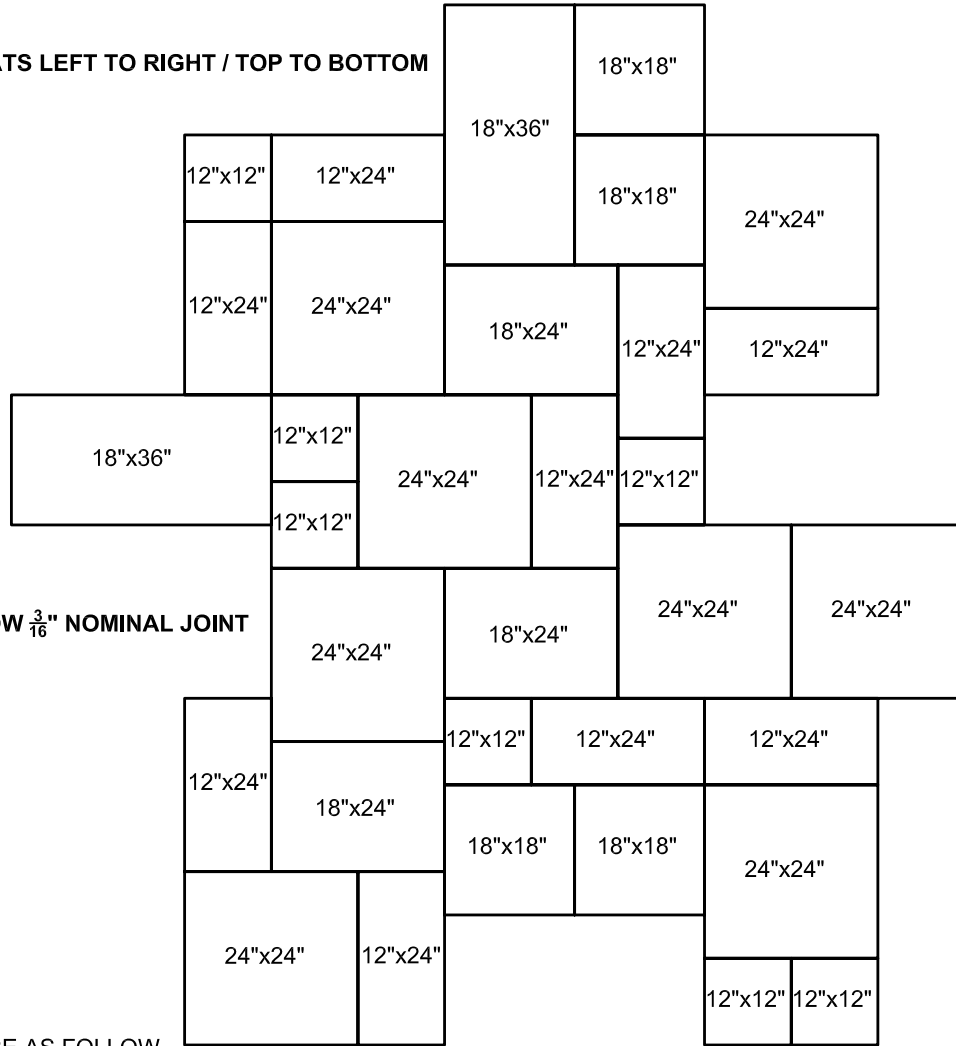

Note:
ALLOW $\frac{3}{16}$ " NOMINAL JOINT

NOTES:
PATTERNS ARE AS FOLLOW,

7 PIECES.	12" x 12"	(1 S.F. EACH).....	7 SQUARE FEET
9 PIECES.	12" x 24"	(2 S.F. EACH).....	18 SQUARE FEET
8 PIECES.	24" x 24"	(4 S.F. EACH).....	32 SQUARE FEET
4 PIECES.	18" x 18"	(2.25 S.F. EACH).....	9 SQUARE FEET
3 PIECES.	18" x 24"	(3 S.F. EACH).....	9 SQUARE FEET
2 PIECES.	18" x 36"	(4.5 S.F. EACH).....	9 SQUARE FEET

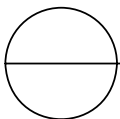

ASHLAR PATTERN GUIDE

SCALE: N.T.S.





RANDOM PATTERN GUIDES

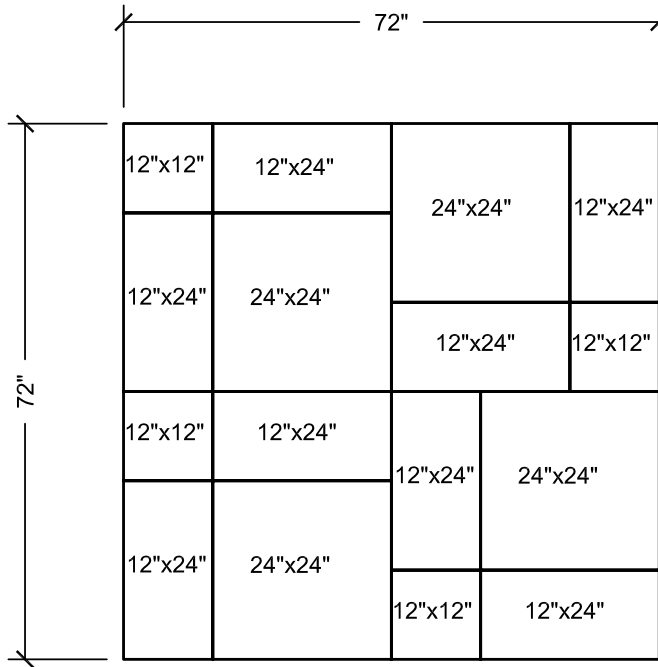

RANDOM PATTERN USING SIZES:

- 12" x 12"
- 12" x 24"
- 24" x 24"

**NOTE:
SIZES NOMINAL**

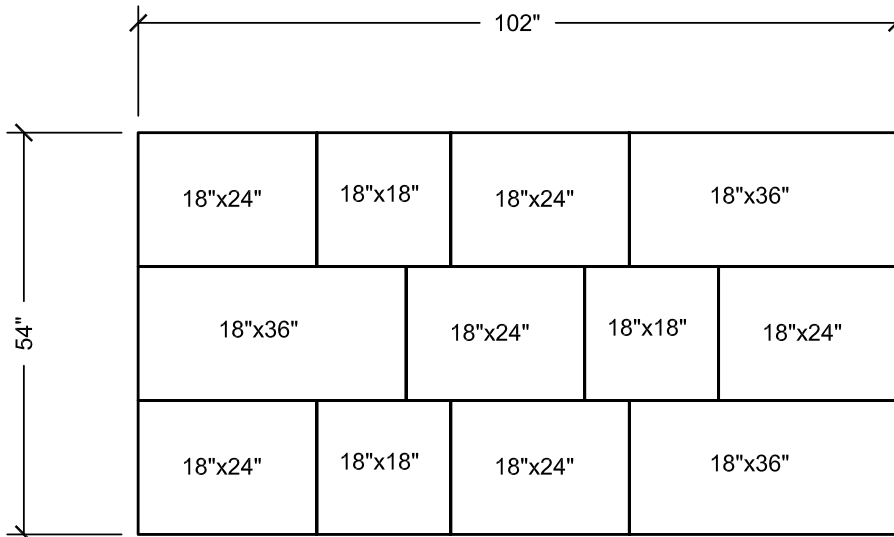

RANDOM PATTERN USING SIZES:

- 18" x 18"
- 18" x 24"
- 18" x 36"

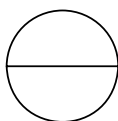

RANDOM PATTERN GUIDES

SCALE: N.T.S.





RANDOM PATTERN GUIDES

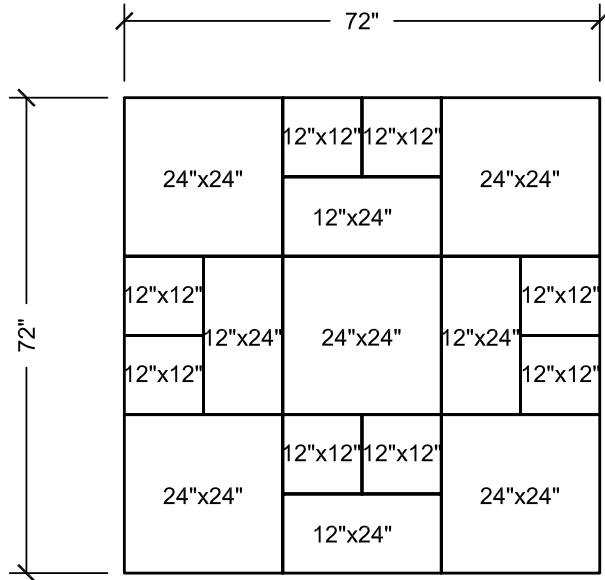

**RANDOM PATTERN
USING SIZES:**

- 12" x 12"
- 12" x 24"
- 24" x 24"

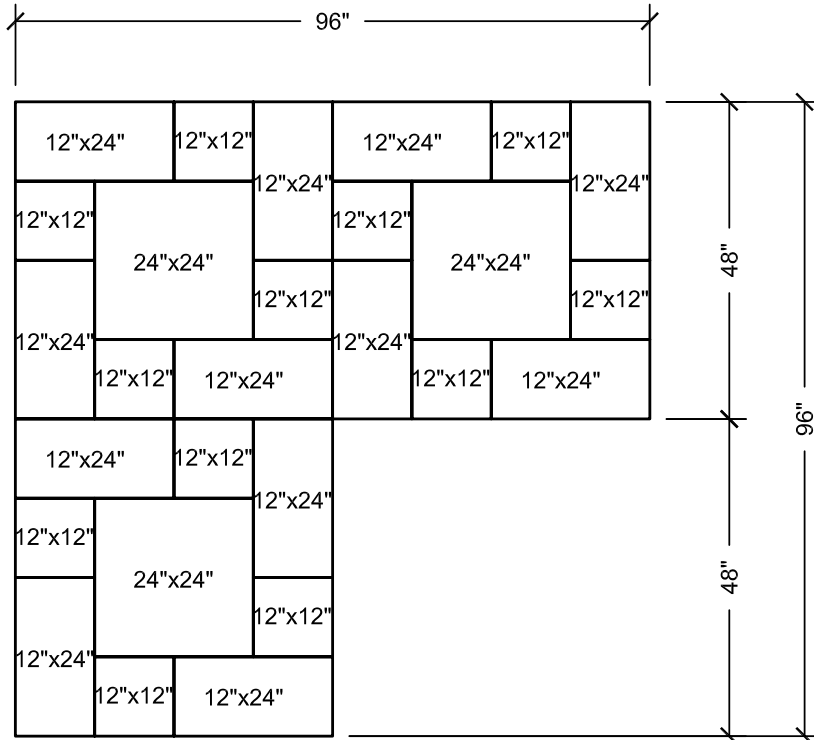

**RANDOM PATTERN
USING SIZES:**

- 12" x 12"
- 12" x 24"
- 24" x 24"

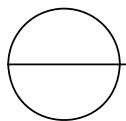

RANDOM PATTERN GUIDES

SCALE: N.T.S.

